

SFE
Female Elbow

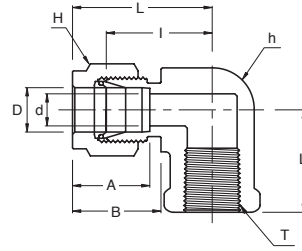

Connects Fractional Tubes To Male NPT Thread

| Part No. | Tube O.D. D (inch) | T* (NPT) | d Min | Width Across Flat | | A | B | I | L | L ₁ |
|----------------|-----------------------|-------------|----------|-------------------|----------|-------|-------|-------|-------|----------------|
| | | | | h (inch) | H (inch) | | | | | |
| SFE - 2 - 2N | 1/8 | 1/8 | 2.28 | 1/2 | 7/16 | 12.70 | 15.24 | 18.03 | 24.63 | 19.05 |
| SFE - 2 - 4N | 1/8 | 1/4 | 2.28 | 11/16 | 7/16 | 12.70 | 15.24 | 20.82 | 27.43 | 22.35 |
| SFE - 3 - 2N | 3/16 | 1/8 | 3.04 | 1/2 | 1/2 | 13.71 | 16.00 | 18.79 | 25.40 | 19.05 |
| SFE - 4 - 2N | 1/4 | 1/8 | 4.82 | 1/2 | 9/16 | 15.24 | 17.78 | 19.55 | 26.92 | 19.05 |
| SFE - 4 - 4N | 1/4 | 1/4 | 4.82 | 11/16 | 9/16 | 15.24 | 17.78 | 22.35 | 29.71 | 22.35 |
| SFE - 4 - 6N | 1/4 | 3/8 | 4.82 | 13/16 | 9/16 | 15.24 | 17.78 | 24.38 | 31.75 | 22.35 |
| SFE - 4 - 8N | 1/4 | 1/2 | 4.82 | 1 | 9/16 | 15.24 | 17.78 | 27.17 | 34.54 | 28.44 |
| SFE - 5 - 2N | 5/16 | 1/8 | 6.35 | 9/16 | 5/8 | 16.25 | 18.54 | 21.33 | 28.70 | 19.05 |
| SFE - 5 - 4N | 5/16 | 1/4 | 6.35 | 11/16 | 5/8 | 16.25 | 18.54 | 23.11 | 30.48 | 22.35 |
| SFE - 6 - 2N | 3/8 | 1/8 | 7.11 | 5/8 | 11/16 | 16.76 | 19.30 | 23.11 | 30.48 | 19.05 |
| SFE - 6 - 4N | 3/8 | 1/4 | 7.11 | 11/16 | 11/16 | 16.76 | 19.30 | 23.87 | 31.24 | 22.35 |
| SFE - 6 - 6N | 3/8 | 3/8 | 7.11 | 13/16 | 11/16 | 16.76 | 19.30 | 25.90 | 33.27 | 22.35 |
| SFE - 6 - 8N | 3/8 | 1/2 | 7.11 | 1 | 11/16 | 16.76 | 19.30 | 28.70 | 36.06 | 28.44 |
| SFE - 8 - 4N | 1/2 | 1/4 | 10.41 | 13/16 | 7/8 | 22.86 | 21.84 | 25.90 | 36.06 | 22.35 |
| SFE - 8 - 6N | 1/2 | 3/8 | 10.41 | 13/16 | 7/8 | 22.86 | 21.84 | 25.90 | 36.06 | 22.35 |
| SFE - 8 - 8N | 1/2 | 1/2 | 10.41 | 1 | 7/8 | 22.86 | 21.84 | 28.70 | 38.86 | 37.00 |
| SFE - 10 - 6N | 5/8 | 3/8 | 12.70 | 15/16 | 1 | 24.38 | 21.84 | 27.94 | 38.10 | 22.35 |
| SFE - 10 - 8N | 5/8 | 1/2 | 12.70 | 1-1/16 | 1 | 24.38 | 21.84 | 29.71 | 39.87 | 28.44 |
| SFE - 12 - 8N | 3/4 | 1/2 | 15.74 | 1-1/16 | 1-1/8 | 24.38 | 21.84 | 29.71 | 39.87 | 28.44 |
| SFE - 12 - 12N | 3/4 | 3/4 | 15.74 | 1-3/8 | 1-1/8 | 24.38 | 21.84 | 34.54 | 44.70 | 31.75 |
| SFE - 14 - 12N | 7/8 | 3/4 | 18.28 | 1-3/8 | 1-1/4 | 25.90 | 21.84 | 34.54 | 44.70 | 31.75 |
| SFE - 16 - 12N | 1 | 3/4 | 22.35 | 1-3/8 | 1-1/2 | 31.24 | 26.41 | 36.83 | 49.02 | 31.75 |
| SFE - 16 - 16N | 1 | 1 | 22.35 | 1-11/16 | 1-1/2 | 31.24 | 26.41 | 41.40 | 53.59 | 38.10 |

* ISO Tapered Threads are available upon request

Connects Metric Tubes To Male NPT Thread

| Part No. | Tube O.D. D | T* (NPT) | d Min | Width Across Flat | | A | B | I | L | L ₁ |
|----------------|----------------|-------------|----------|-------------------|----|------|------|------|------|----------------|
| | | | | h | H | | | | | |
| SFE - 6M - 4N | 6 | 1/4 | 4.8 | 17.46 | 14 | 15.3 | 17.7 | 22.4 | 29.8 | 22.40 |
| SFE - 6M - 6N | 6 | 3/8 | 4.8 | 20.63 | 14 | 15.3 | 17.7 | 24.4 | 31.7 | 22.40 |
| SFE - 6M - 8N | 6 | 1/2 | 4.8 | 25.40 | 14 | 15.3 | 17.7 | 27.2 | 34.6 | 28.40 |
| SFE - 8M - 4N | 8 | 1/4 | 6.4 | 17.46 | 16 | 16.2 | 18.6 | 23.1 | 30.6 | 22.40 |
| SFE - 8M - 8N | 8 | 1/2 | 6.4 | 20.63 | 16 | 16.2 | 18.6 | 28.0 | 35.2 | 28.40 |
| SFE - 10M - 4N | 10 | 1/4 | 7.9 | 17.46 | 19 | 17.2 | 19.5 | 25.9 | 33.5 | 22.40 |
| SFE - 10M - 6N | 10 | 3/8 | 7.9 | 20.63 | 19 | 17.2 | 19.5 | 25.9 | 33.5 | 22.40 |
| SFE - 10M - 8N | 10 | 1/2 | 7.9 | 25.40 | 19 | 17.2 | 19.5 | 28.7 | 36.1 | 28.40 |
| SFE - 12M - 6N | 12 | 3/8 | 9.5 | 20.63 | 22 | 22.8 | 22.0 | 25.9 | 36.2 | 22.35 |
| SFE - 12M - 8N | 12 | 1/2 | 9.5 | 25.40 | 22 | 22.8 | 22.0 | 28.7 | 38.8 | 28.40 |

* ISO Tapered Threads are available upon request

• All dimensions in millimeters unless specified as "inch". Dimension are for reference only, subject to change